

F. REVIS.		<b>BANDALUX</b>	
REVISION	1 2 3 4 5 6 7 8 9		
FECHA	11-01-2017	PLANO Nº	
DIBUJADO	Antonio F.	FORMATO	A-4
ESCALA	Cortina enrollable Premium Plus I Cadena Guía U-301 Soportes instalación a techo. Guía U-301 instalación lateral Mecanismo VTX20 Terminal oculto de $\varnothing20$ mm Tubo $\varnothing44$ mm		
<b>1/1</b>			

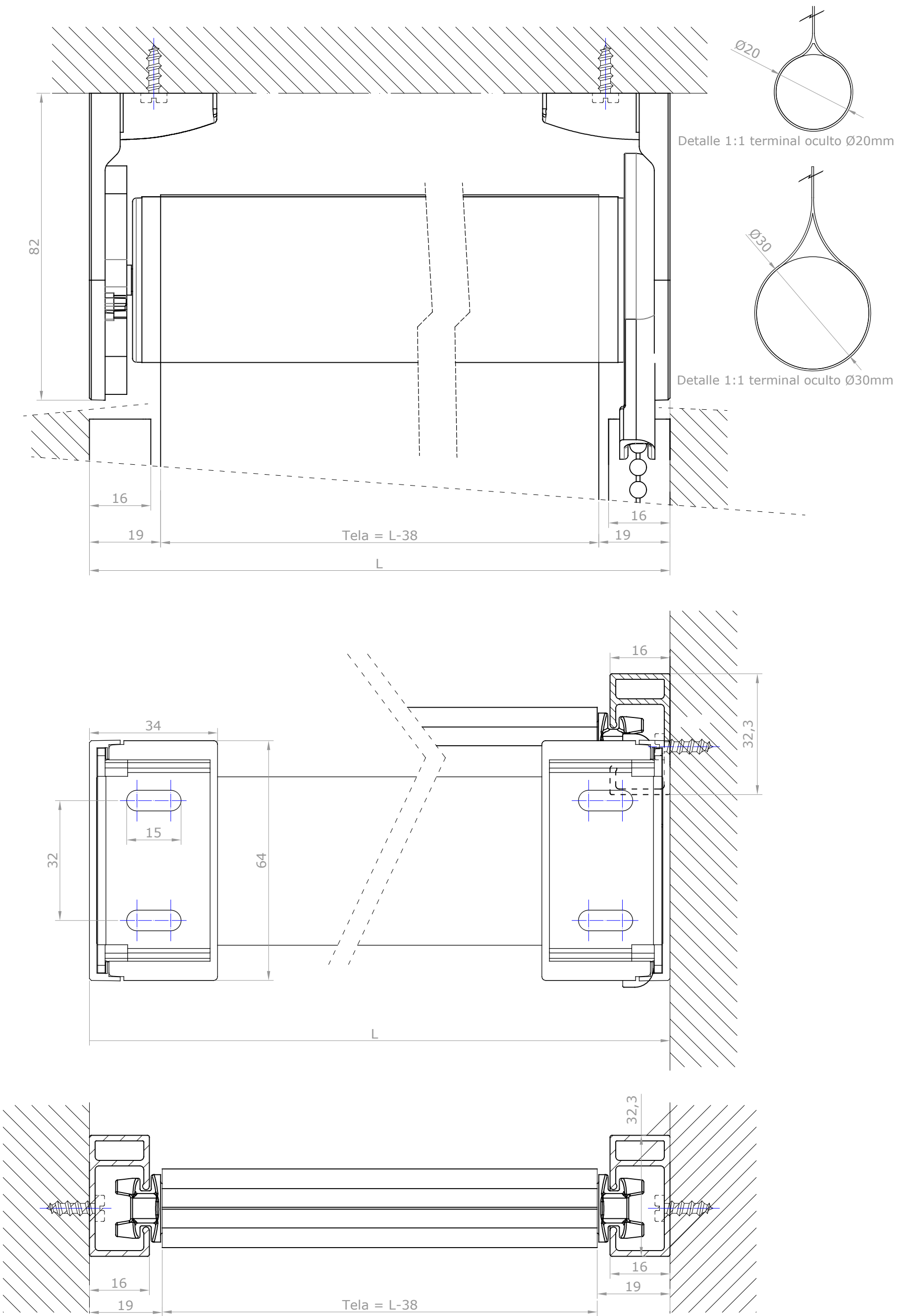

F. REVIS.		BANDALUX	
REVISION	123456789		
FECHA	11-01-2017	PLANO Nº	
DIBUJADO	Antonio F.	FORMATO	A-3
ESCALA	Cortina enrollable Premium Plus I Cadena Guía U-301 Soportes instalación a techo. Guía U-301 instalación lateral Mecanismo VTX20 Terminal oculto de Ø20mm Tubo Ø44mm		
1/1			

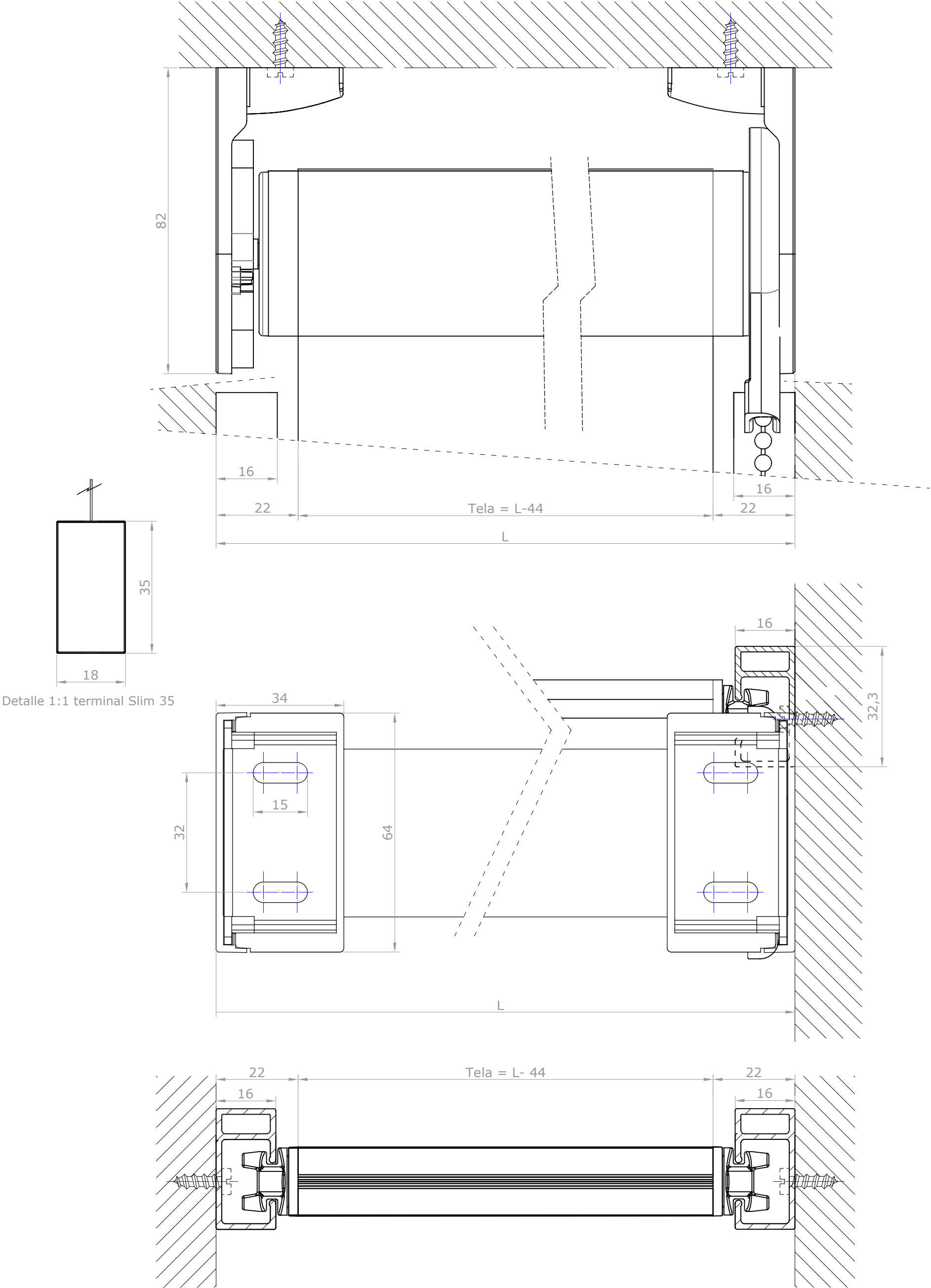

F. REVIS.	BANDALUX		
REVISION			
FECHA	29-01-2018	PLANO N°	
DIBUJADO	Miquel P.	FORMATO	A-3
ESCALA	Cortina enrollable Premium Plus I Cadena Guía U-301 Soportes instalación a techo. Guía U-301 instalación lateral Mecanismo VTX20 Terminal Slim 35 Tubo Ø44mm		

1/1

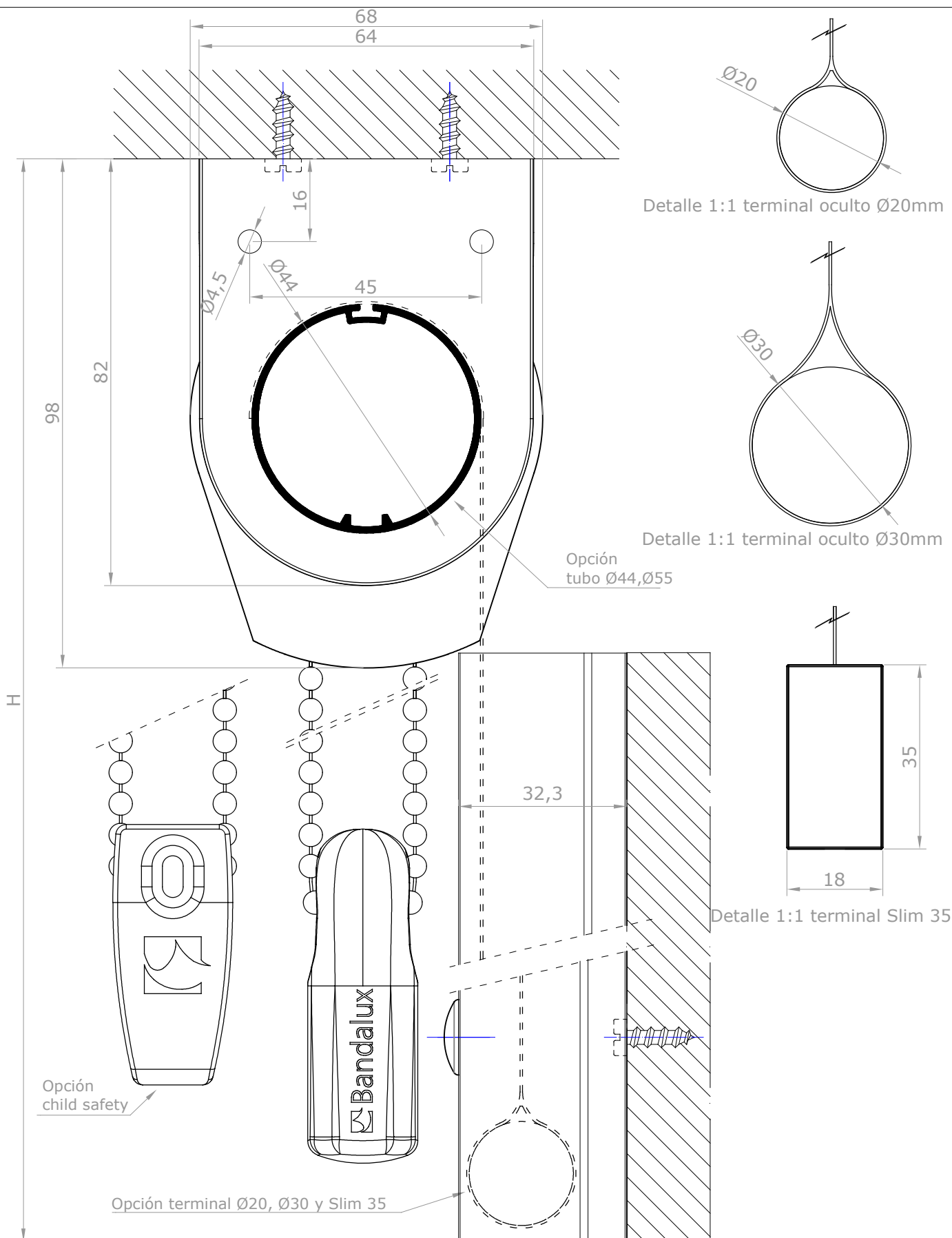

F. REVIS.		<b>BANDALUX</b>	
REVISION	1 2 3 4 5 6 7 8 9		
FECHA	11-01-2017	PLANO Nº	
DIBUJADO	Antonio F.	FORMATO	A-4
ESCALA	Cortina enrollable Premium Plus I Cadena Guía U-301 Soportes instalación a techo. Guía U-301 instalación frontal Mecanismo VTX20 Terminal oculto de Ø20mm Tubo Ø44mm		
<b>1/1</b>			

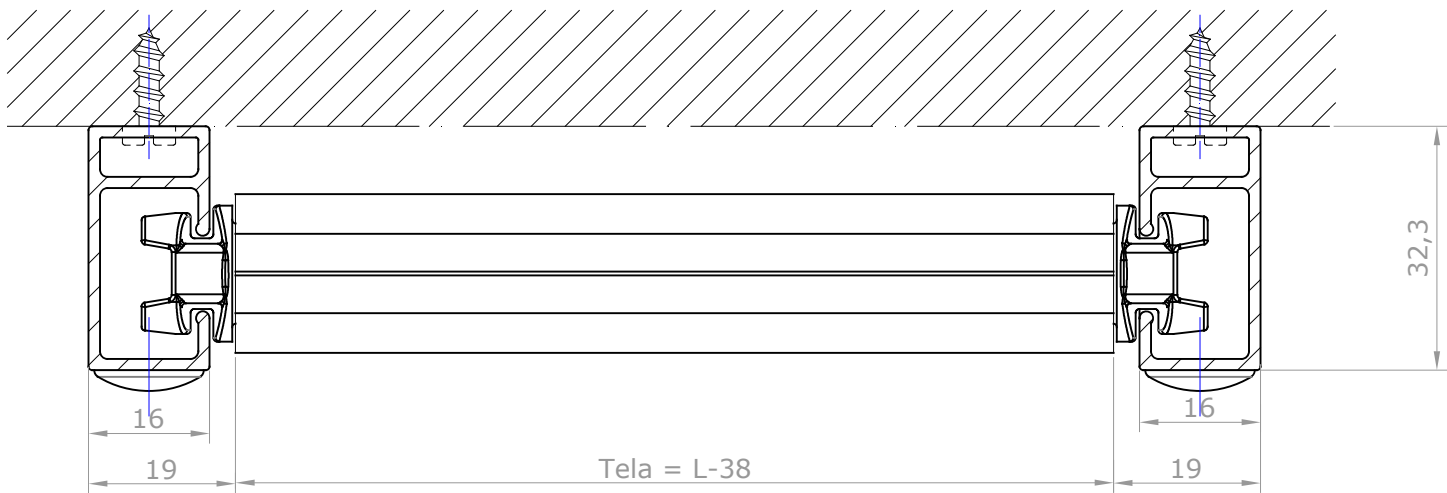
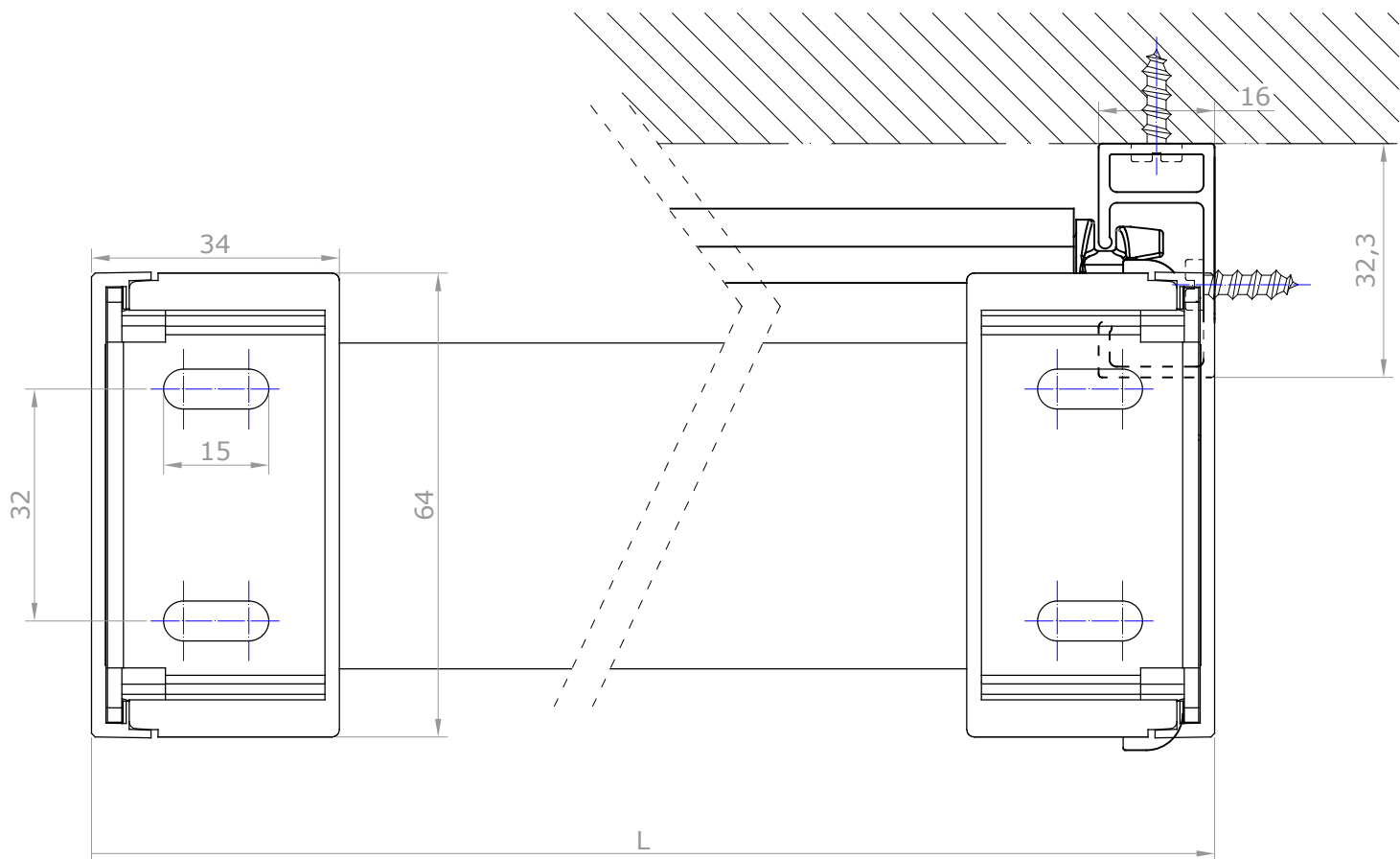
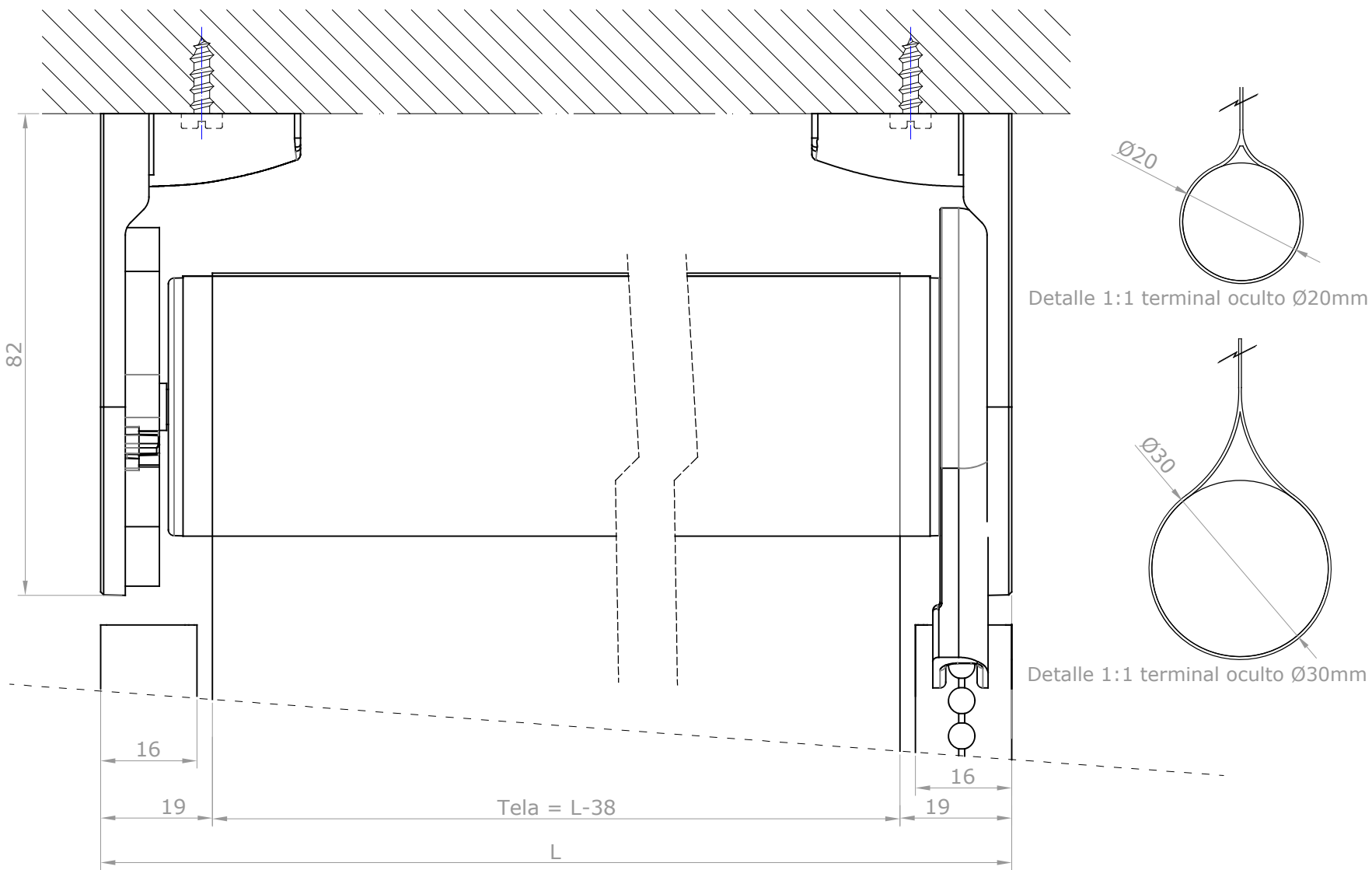

F. REVIS.		BANDALUX	
REVISION	123456789		
FECHA	11-01-2017	PLANO Nº	
DIBUJADO	Antonio F.	FORMATO	A-3
ESCALA	Cortina enrollable Premium Plus I Cadena Guía U-301 Soportes instalación a techo. Guía U-301 instalación frontal Mecanismo VTX20 Terminal oculto de Ø20mm Tubo Ø44mm		

1/1

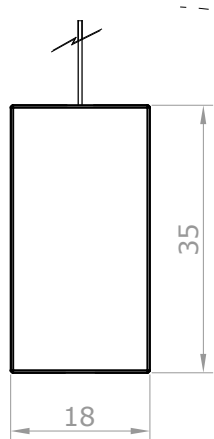

Technical drawing of a two-part metal bracket. The drawing shows two views: a front view on the left and a side view on the right. The front view shows a rectangular bracket with a width of 34 and a height of 64. It has two mounting holes, each with a diameter of 15. The side view shows the bracket's profile, with a total height of 32,3. The bracket is shown in two parts, with a dashed line indicating the assembly point. The drawing includes dimensions for the mounting holes (15), the overall width (34), the overall height (64), and the side view height (32,3). A dimension of 16 is also shown for the side view. The drawing is labeled with 'L' for length and 'h 35' for height.

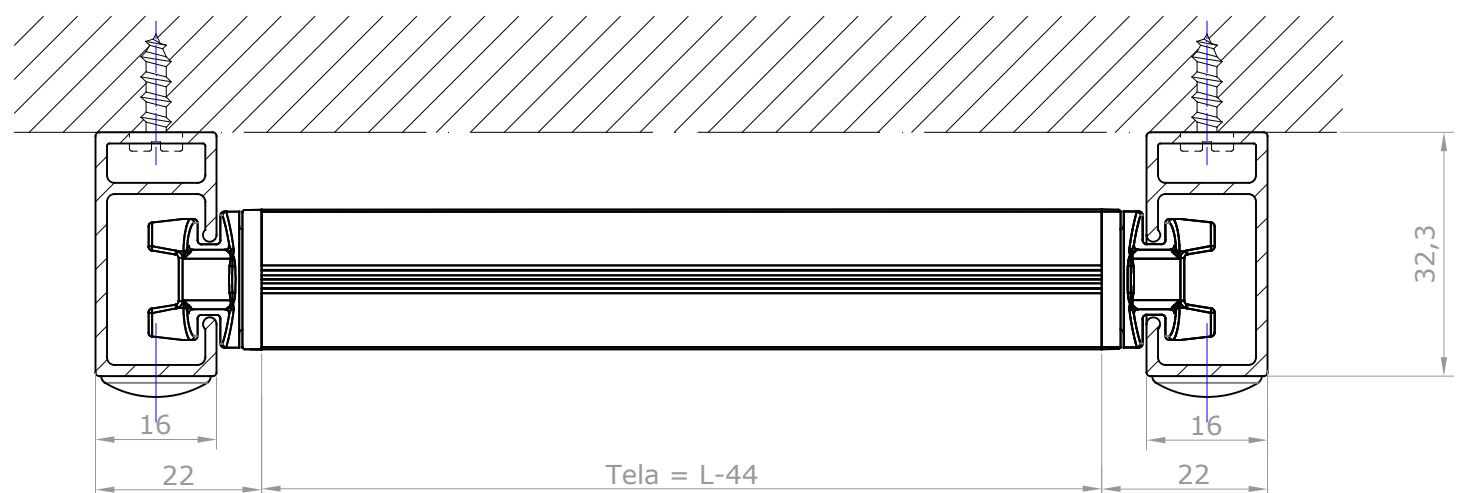

F. REVIS.		BANDALUX	
REVISION	123456789		
FECHA	29-01-2018	PLANO Nº	
DIBUJADO	Miquel P.	FORMATO	A-3
ESCALA <b>1/1</b>	Cortina enrollable Premium Plus I Cadena Guía U-301 Soportes instalación a techo. Guía U-301 instalación frontal Mecanismo VTX20 Terminal Slim 35 Tubo Ø44mm		



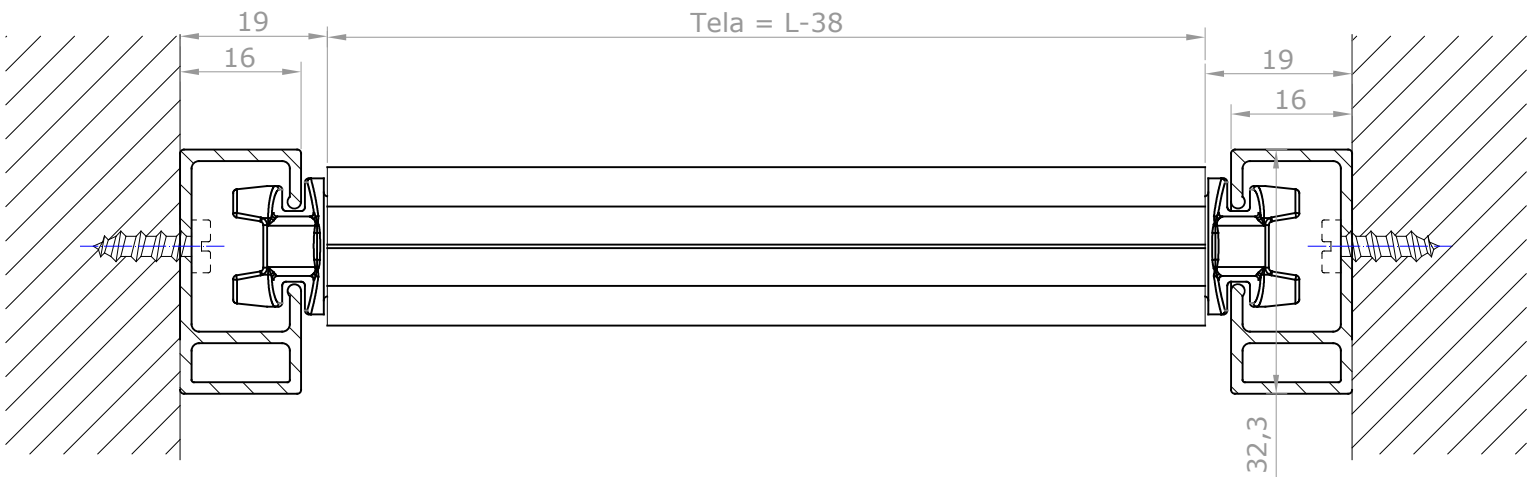
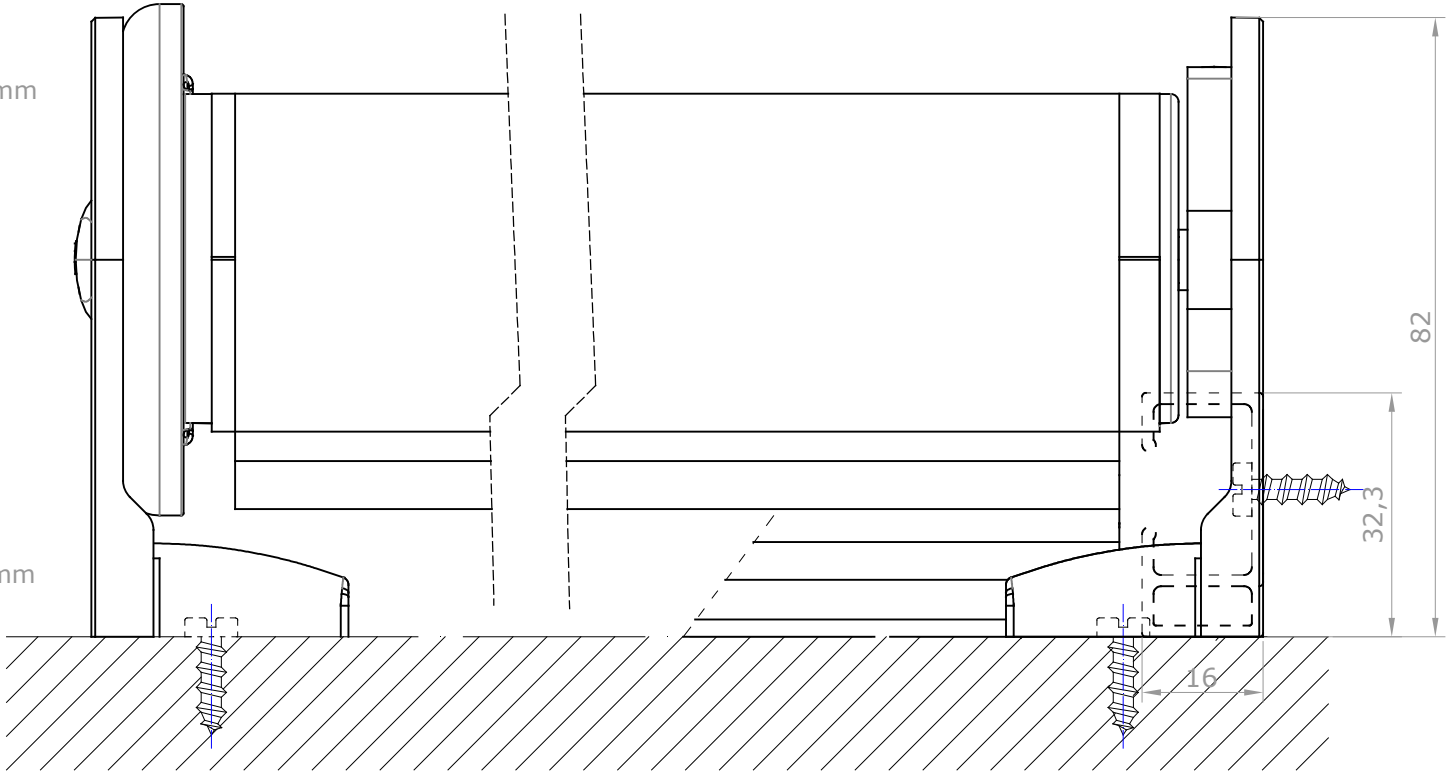
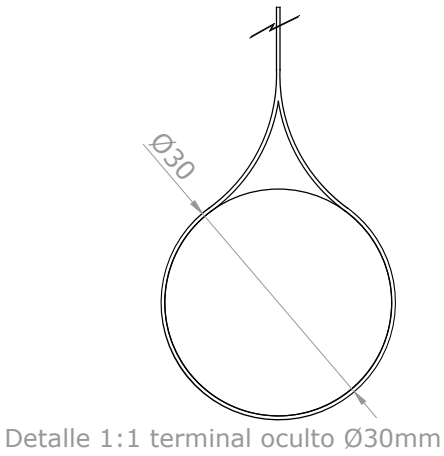
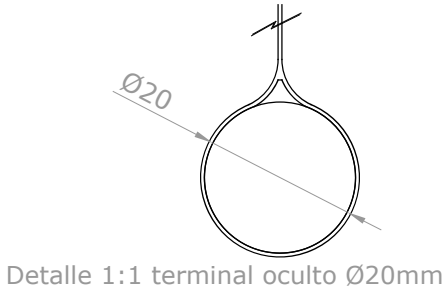
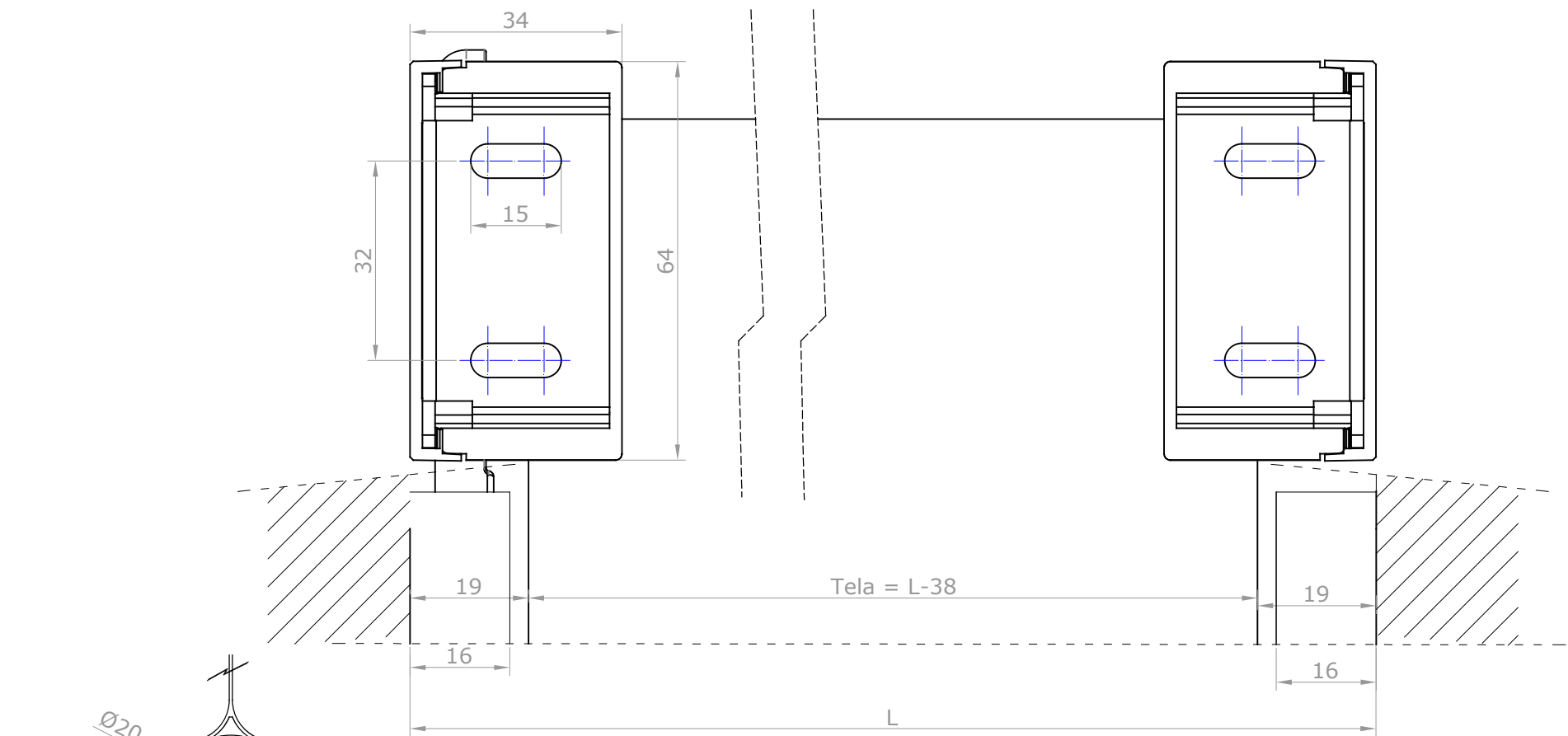

F. REVIS.		<b>BANDALUX</b>	
REVISION	123456789		
FECHA	11-01-2017	PLANO Nº	
DIBUJADO	Antonio F.	FORMATO	A-3
ESCALA	Cortina enrollable Premium Plus I Cadena Guía U-301 Soportes instalación a pared. Guía U-301 instalación lateral Mecanismo VTX20 Terminal oculto de Ø20mm Tubo Ø44mm		
	<b>1/1</b>		



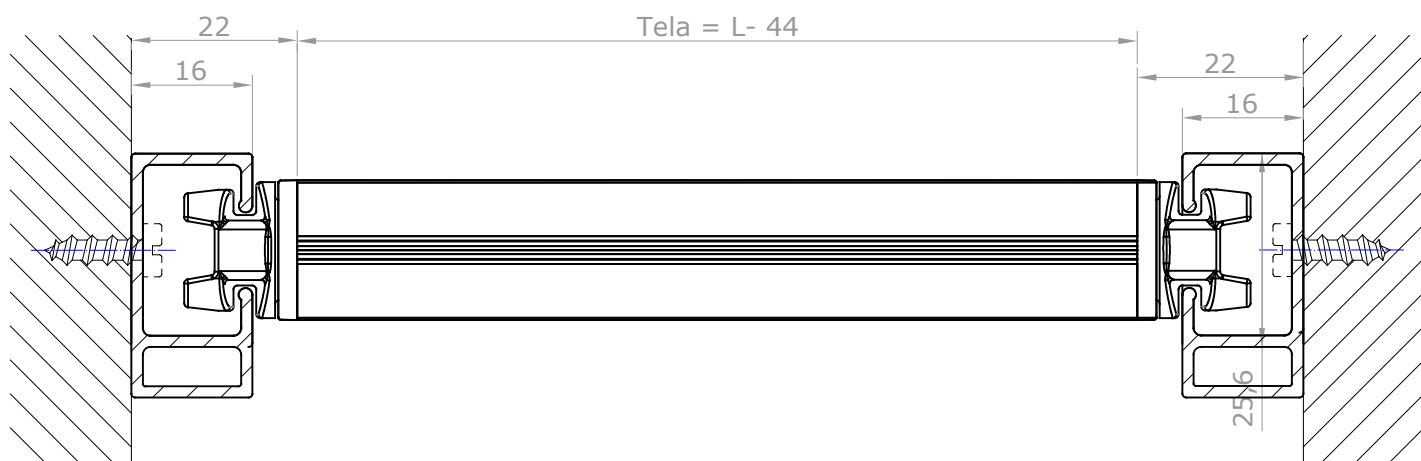
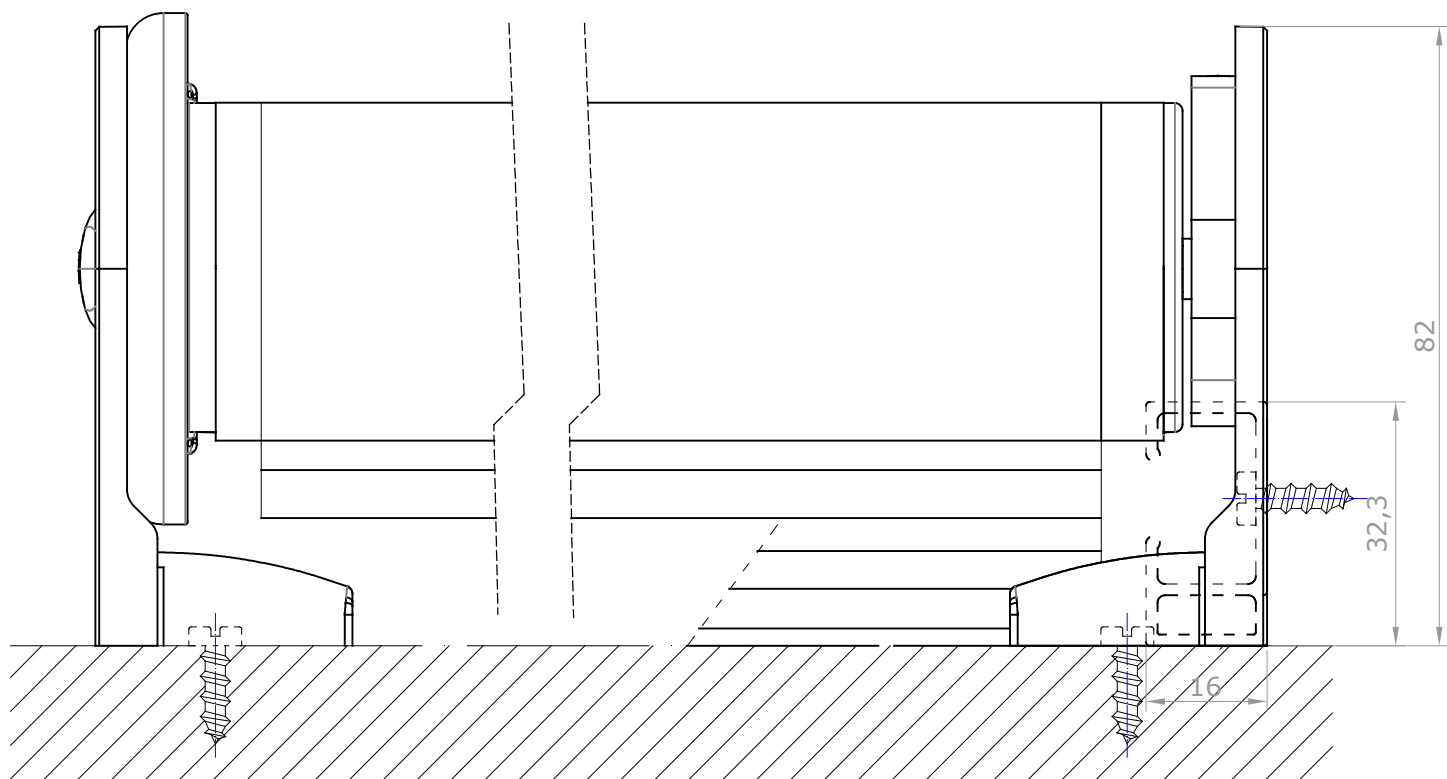
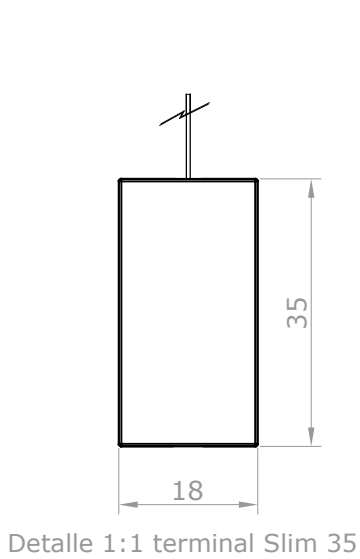
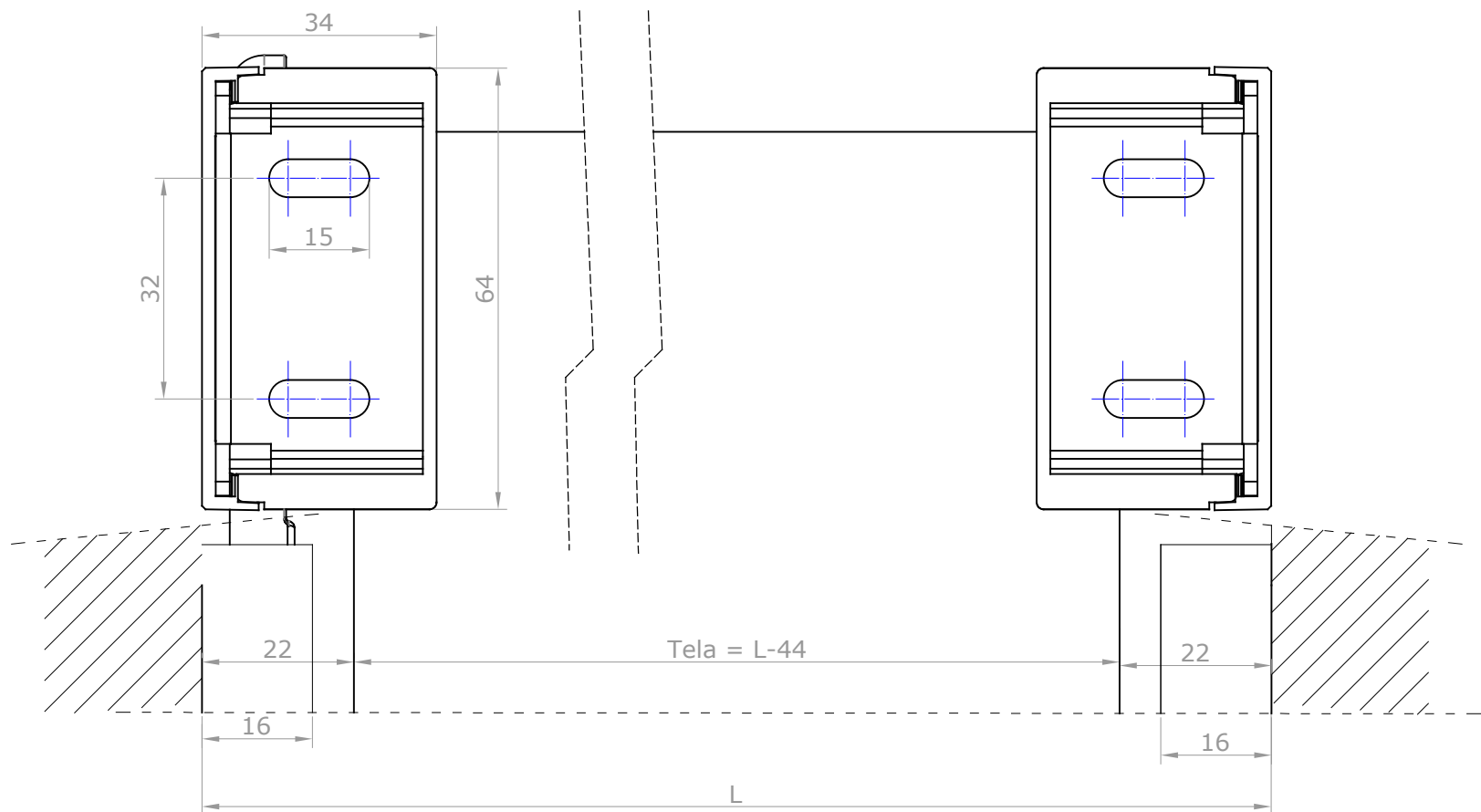

F. REVIS.	BANDALUX		
REVISION			
FECHA	29-01-2018	PLANO N°	
DIBUJADO	Miquel P.	FORMATO	A-3
ESCALA	Cortina enrollable Premium Plus I Cadena Guía U-301 Soportes instalación a pared. Guía U-301 instalación lateral Mecanismo VTX20 Terminal Slim 35 Tubo Ø44mm		
1/1			

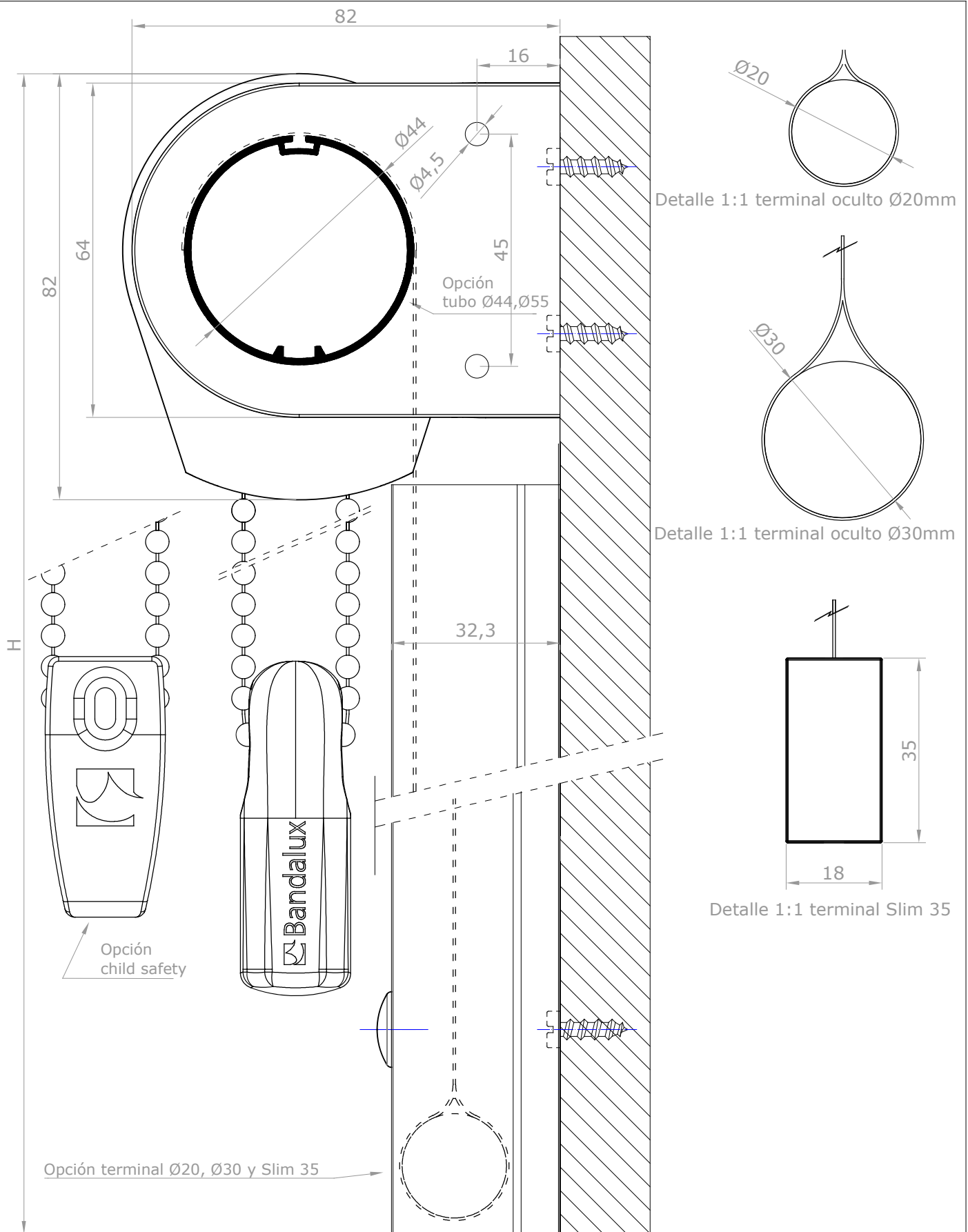

F. REVIS.		<b>BANDALUX</b>	
REVISION	1 2 3 4 5 6 7 8 9		
FECHA	11-01-2017	PLANO Nº	
DIBUJADO	Antonio F.	FORMATO	A-4
ESCALA	Cortina enrollable Premium Plus I Cadena Guía U-301 Soportes instalación a pared. Guía U-301 instalación frontal Mecanismo VTX20 Terminal oculto de Ø20mm Tubo Ø44mm		
<b>1/1</b>			

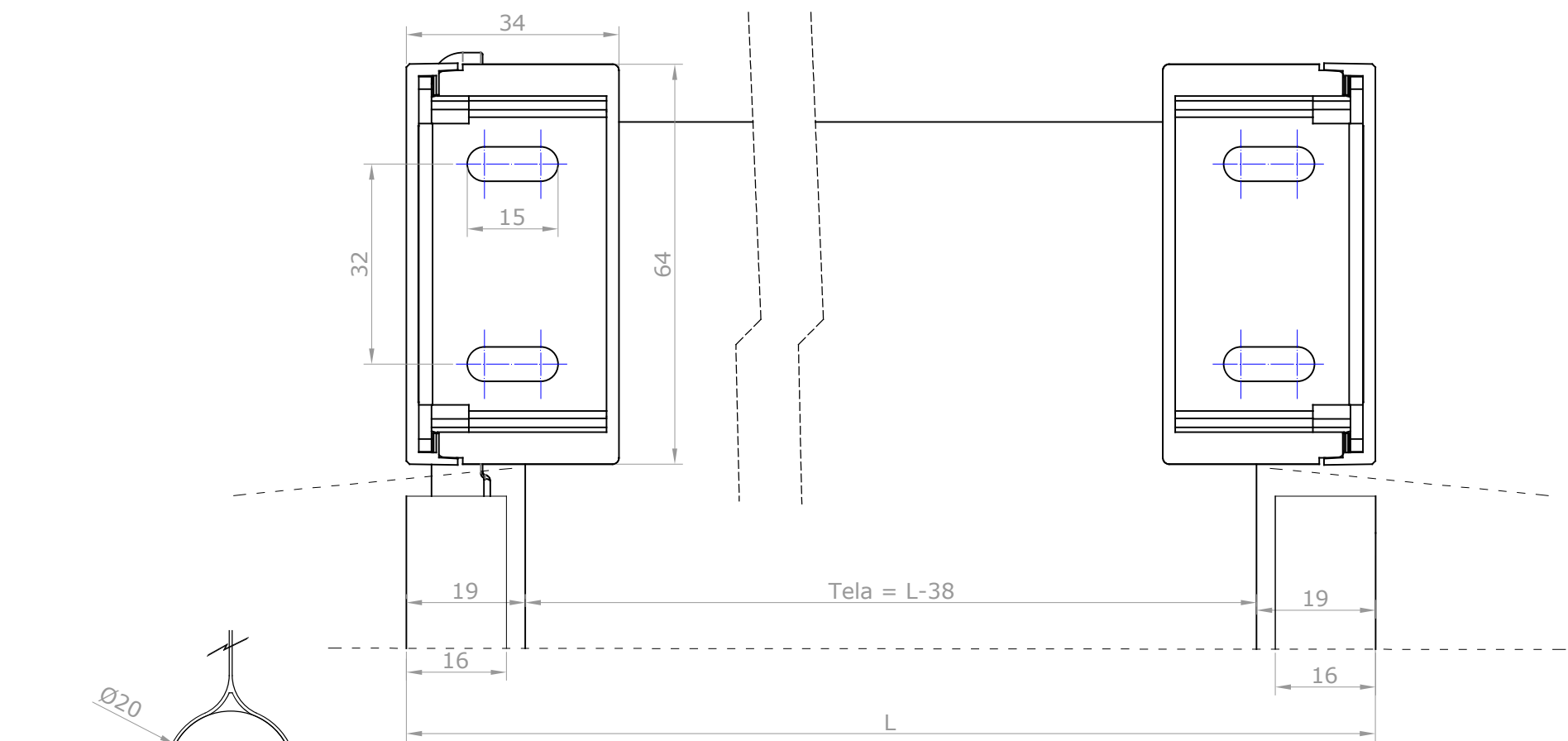

Detalle 1:1 terminal oculto Ø20mm

Detalle 1:1 terminal oculto Ø30mm

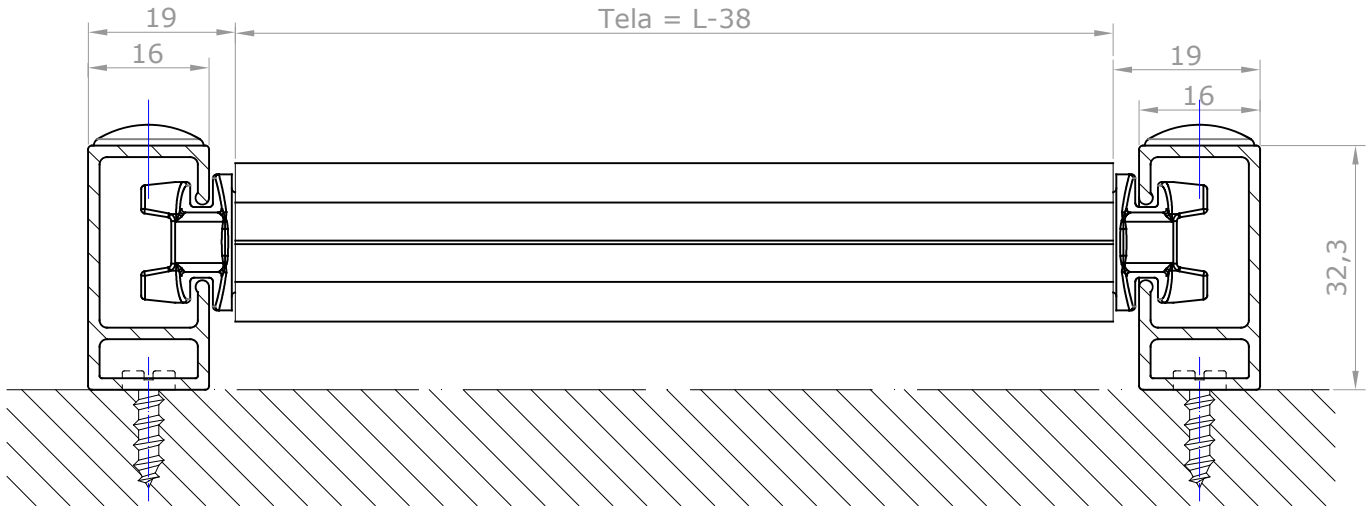
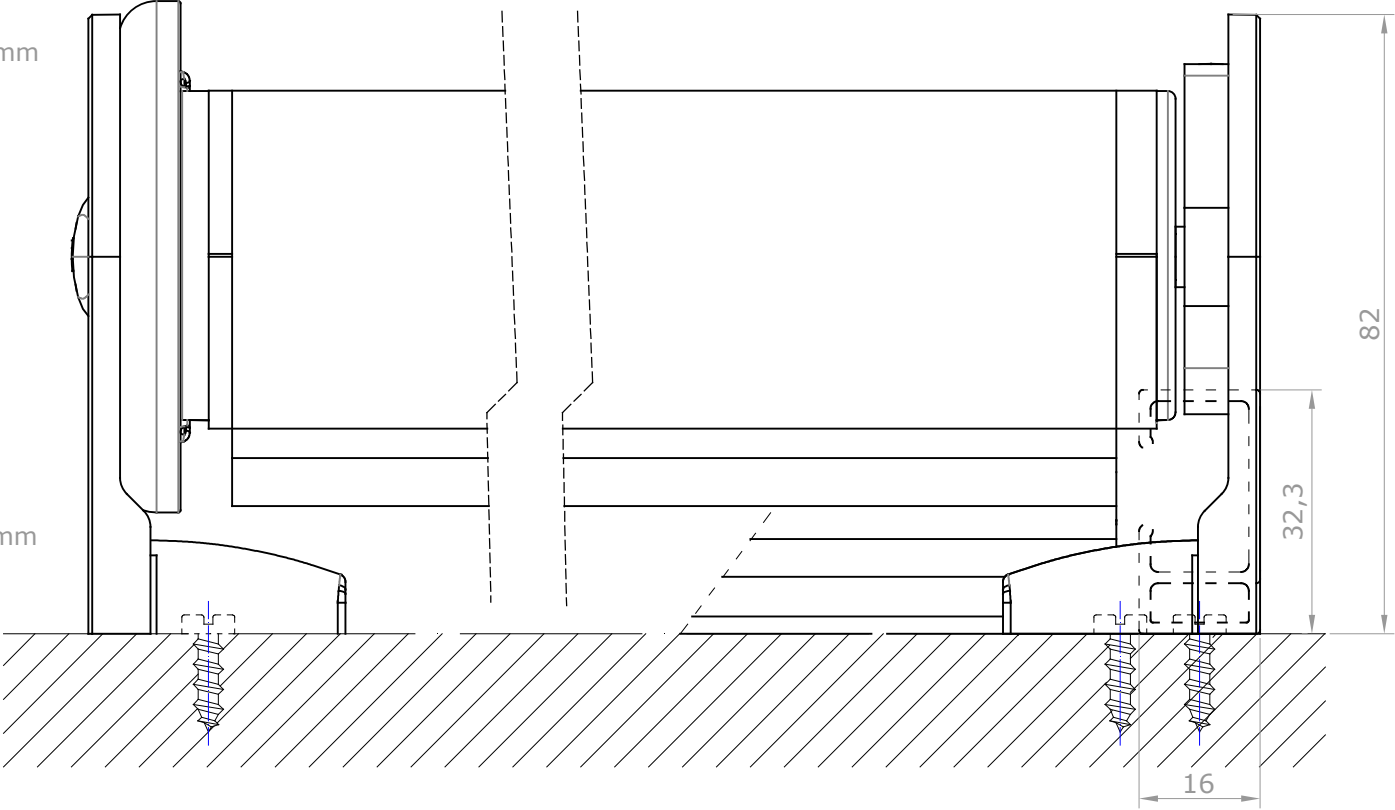

F. REVIS.	BANDALUX		
REVISION			
FECHA	11-01-2017	PLANO N°	
DIBUJADO	Antonio F.	FORMATO	A-3
ESCALA	Cortina enrollable Premium Plus I Cadena Guía U-301 Soportes instalación a pared. Guía U-301 instalación frontal Mecanismo VTX20 Terminal oculto de Ø20mm Tubo Ø44mm		

1/1

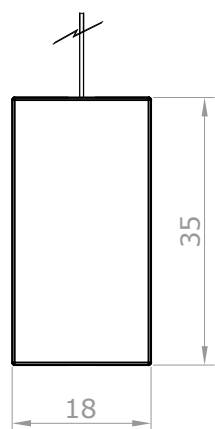

Detalle 1:1 terminal Slim 35

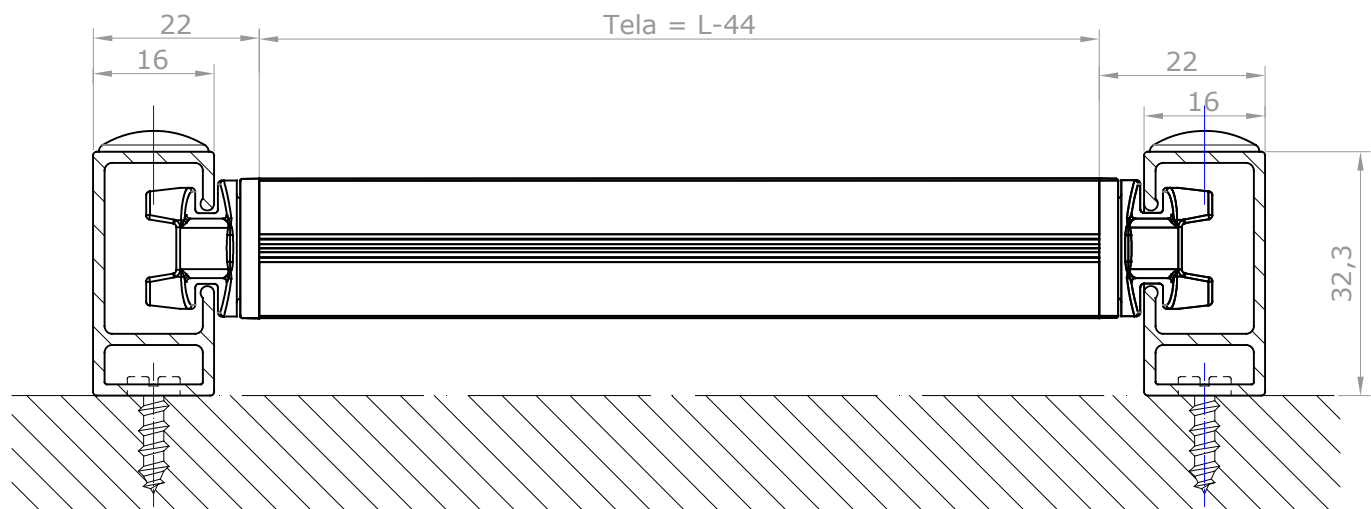
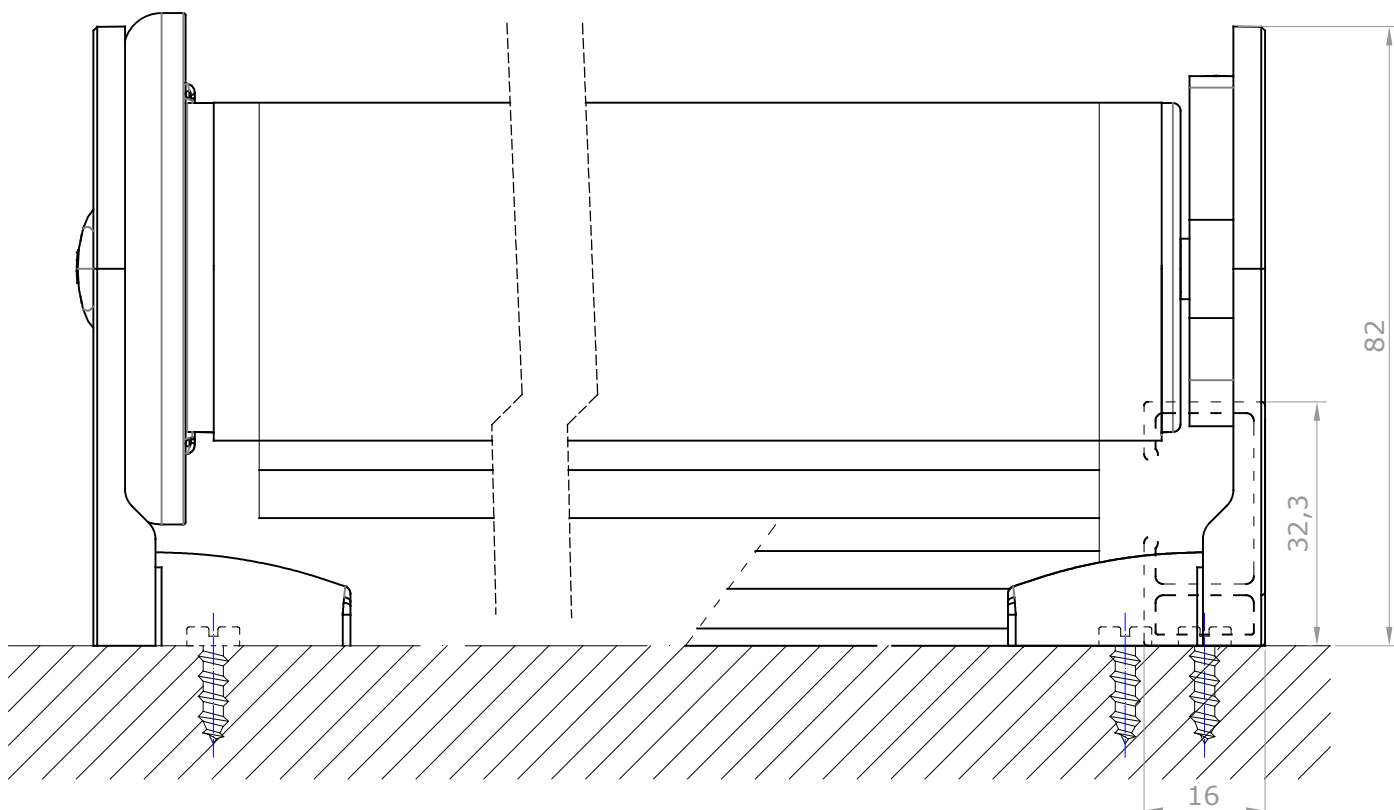
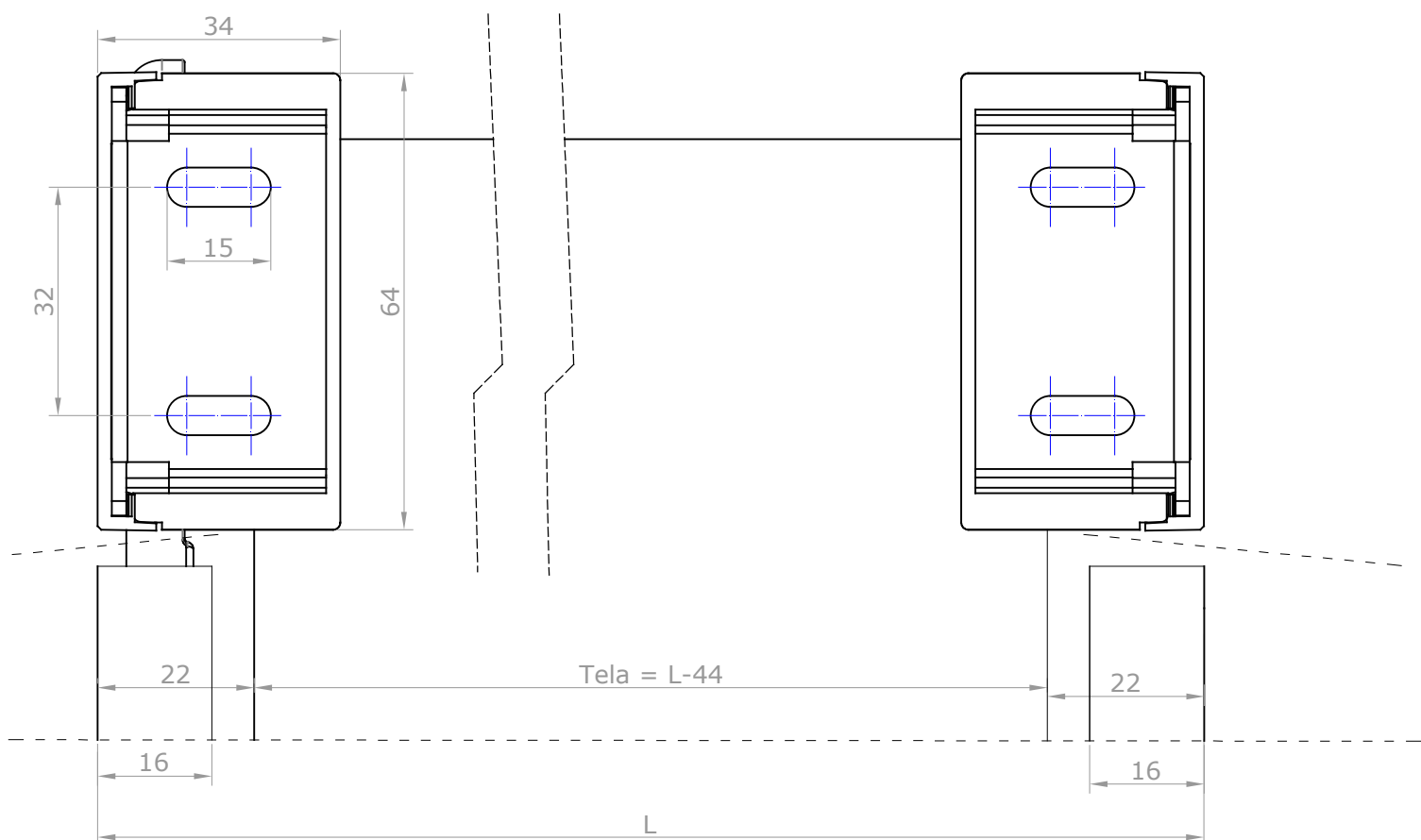

F. REVIS.		BANDALUX	
REVISION	123456789		
FECHA	29-01-2018	PLANO N°	
DIBUJADO	Miquel P.	FORMATO	A-3
ESCALA	Cortina enrollable Premium Plus I Cadena Guía U-301 Soportes instalación a pared. Guía U-301 instalación frontal Mecanismo VTX20 Terminal Slim 35 Tubo Ø44mm		
1/1			